

# CUTWATER 30 S



Cutwater's largest family cruiser offers all the advantages of Cutwater's exclusive Stepped Keel hull design, in a larger boat that provides even more interior room, standard features and comfortable on board living. An ingenious new cockpit seating arrangement welcomes up to seven adults without crowding, and a new Euro-style galley conceals appliances beneath a hinged counter-top that's ideal for buffet or refreshment service.

The Cutwater 30 accommodates six on three separate berths, for exceptional privacy and comfort even on extended cruises. On the fore deck, two flush hatches open to reveal cushioned, secure observation seats, along with a central forward lounge. Add to this a long list of other features and the reliable performance of the 435-h.p. Volvo diesel engine for efficient express service to distant waterways, and you have a masterpiece of innovation that ensures unsurpassed enjoyment, year after year.

## Specifications

LOA molded	30' 0"	9.14 m
LOA rigged (with swim & pulpit)	34' 4"	10.46 m
Bridge clearance (bridge folded)	9' 9"	2.97 m
Beam	10' 0"	3.05 m
Draft	29"	.73 m
Height on trailer	13' 2"	4.01 m
Length on trailer	40' 2"	12.24 m
Fuel capacity	180 U.S. Gal	681.4 L
Water capacity	80 U.S. Gal	302.8 L
Holding tank capacity	40 U.S. Gal	151.4 L
Weight (dry)	10,200 lbs	4,626 kg
Engine	Volvo D6, 435 HP	Common Rail Electronic Engine

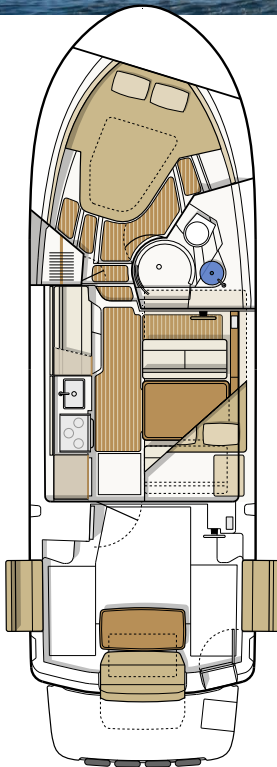

## Standard Features

### Performance

Volvo D6 435 HP diesel with color display  
Fuel flow data display  
Single-Lever engine control, electronic controls (Volvo)  
Thrusters, bow and stern  
Trim Tabs



### Boater Features

Anchor locker, S.S. self launching bow roller  
Batteries (6) w/charging relay & switch panel  
Bow platform w/4 rung S.S. ladder (beach access)  
Bow seats/ fender storage  
Cockpit table, Cherry, removable  
Cockpit sink and shower  
Companion lounge seat  
Convertible cockpit seats, fold out of gunwales  
Docking lights, (2) forward hull  
Fusion stereo system, (6) speakers, AM/FM, Aux, Bluetooth  
Hatches (2), forward cabin roof, opening, translucent w/screens  
Hatches (4), salon house roof, opening, translucent w/screens  
Inverter, 2,000w, PSW  
Mast, stainless steel, hinged  
Memory foam island berth, master stateroom  
Mid cabin, 6' 8" cushioned, portlights, lamps, gear storage  
Opening bulkhead w/reversible dinette seat  
Portlight, opening, head (1), forward stateroom (5)  
Powered engine hatch  
Reversible cockpit seat  
Rod holders (2)  
Seawater strainer  
Sport racks  
Storage lockers, cabin doors  
Swim platform w/S.S. 4 rung ladder, integrated fenders  
Transom door  
TVs 22" (2) w/DVD, salon and master stateroom (12v)  
Washdown system, cockpit raw water  
Water tank level monitor (fresh)  
Windlass 12V, stainless steel with helm and bow controls

### Convenience

Cabin heater, (Engine FWC)  
Dinette, salon, converts to bed, high/low table, sleeps (2)  
Euro-style covered galley, Maple  
Hanging locker  
Hot water tank, 11 gallon, (Eng - 110V)  
Midship stateroom sleeps two, 110V, 12V, reading light  
Outlets 110V (5)  
Power outlet, 12v stbd side, cockpit, mid berth

Private head, shower enclosure, elec. toilet, vanity, portlights  
Refrigerator/freezer, 12V  
Sink, hot and cold water system w/demand pump  
Wine-water cooler, 12V

### Construction

Bonded 12V electrical system  
Bronze rudder, propeller, and thru-hulls  
Fiberglass cockpit liner, self bailing w/non-skid  
Fiberglass stringer system  
S.S. cleats, rails, ext. hardware  
Shorepower 30 amp/115v, w/50' cord  
Teak and holly cabin sole  
Vinylester barrier coat (hull)

### Safety

Bilge pump, (2) 12V auto, high bilge alarm  
Co monitors (2), 12V  
Courtesy lights, cockpit, transom platform  
Horns, electric dual trumpet  
Illuminated Compass  
Navigation lights, with light boards  
VHF radio, Garmin with antenna, DSC capable  
Windshield wipers (2)

## Additional Factory Options

Aft cockpit sun and sunset shades	\$1,500
Aft cockpit bimini top with boot	\$3,440
Aft steering, second station with electronic controls	\$4,970
Aluminum triple axle trailer, electric/hydraulic brakes, spare tire w/bracket	\$15,600
Cockpit ice maker in lieu of standard refrigerator	\$470
Dinghy, inflatable RIB 290 CSM hypalon with Weaver davits, stand-off & winch	\$5,125
Dinghy motor, 2.5 HP, 4-stroke, storage bracket	\$1,115
Dinghy motor, 6 HP, 4-stroke, storage bracket	\$1,945
Dinghy motor, 9.9 HP, 4-stroke, storage bracket	\$2,935
Factory Delivery Experience	\$2,500
Garmin GXM 53 XM/weather antenna	\$1,000
Hull color upgrade, Midnight Blue	\$7,500
International option, 240v	\$900
Low speed module	\$2,000
Rocket launchers, arch with rod holders (6)	\$1,050

## Cutwater 30 S Value Package FACTORY DIRECT PRICING

All Cutwater 30's are sold **fully-equipped** and **ready to cruise**. There are two packages to choose from, the Luxury Edition with a diesel generator and air conditioning or the Northwest Edition with a diesel forced air furnace, propane stove and oven, and downrigger plugs and pads.

### Northwest Edition Includes:

- Anchor Package 22# anchor, 50' HT chain, 200' line
- Autopilot, Garmin w/remote
- AGM batteries
- **Diesel heater, forced air furnace**
- **Downrigger plugs and pads**
- LED lights
- Macerator discharge
- Microwave
- Navigation package, Garmin 7612, 4kw radar dome, GPS ant., depth/ff
- Safety kit
- Solar panel, w/control panel
- **Propane stove and oven with tanks (2) and locker**
- Swim platform rails
- Thruster wireless remote (bow and stern)
- Underwater lights

**FULLY EQUIPPED, READY TO CRUISE FROM:**

**\$304,937.00\***

*\*Options, freight & taxes extra*

*Prices, specifications, equipment and options may change without notice. 0818*



### Luxury Edition Includes:

- **Air conditioning/rev cycle heat**
- Anchor Package 22# anchor, 50' HT chain, 200' line
- Autopilot, Garmin w/remote
- AGM batteries
- **Convection oven/microwave combo**
- **Generator, 5KW diesel, w/sound shield**
- LED lights
- Macerator discharge
- Navigation package, Garmin 7612, 4kw radar dome, GPS ant., depth/ff
- Safety kit
- Solar panel, w/control panel
- **Stovetop, dual burner electric**
- Swim platform rails
- Thruster wireless remote (bow and stern)
- Underwater lights

**FULLY EQUIPPED, READY TO CRUISE FROM:**

**\$319,937.00\***



17341 Tye St. S.E.  
Monroe, Washington 98272  
Phone 800.349.7198  
[www.CutwaterBoats.com](http://www.CutwaterBoats.com)