

# CUTWATER 24 DUAL CONSOLE

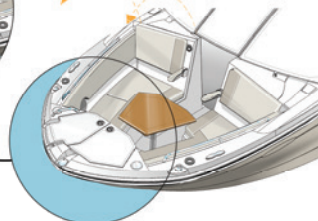
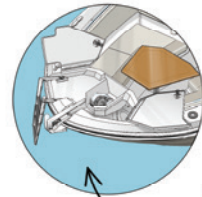
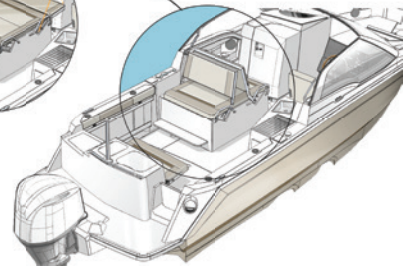
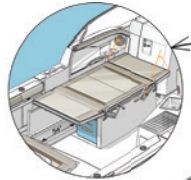
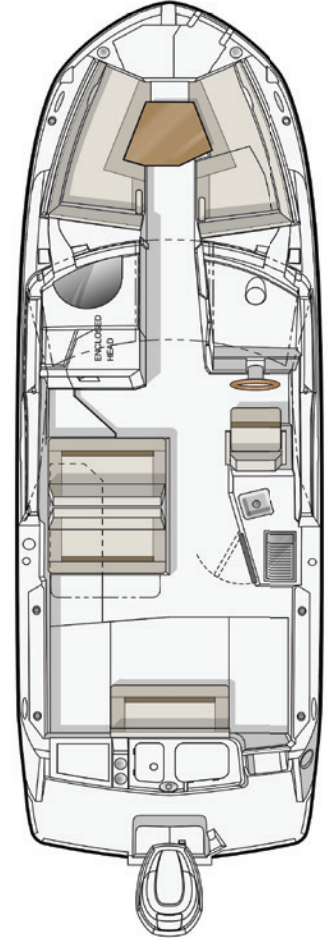
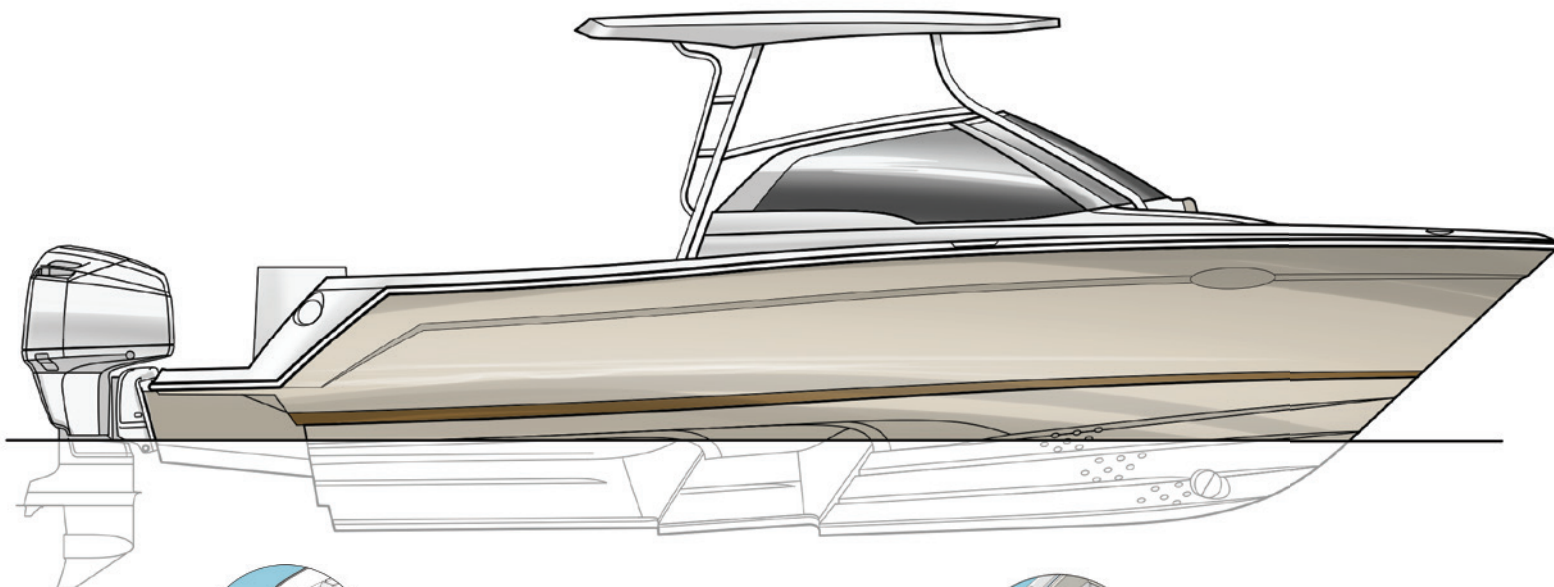

## Specifications

LOH (transom - bow)	26' 6"	8.1 m
LOA (rigged with motor)	29' 2"	8.9 m
Beam	8' 6"	2.6 m
Draft (motor down)	32"	.8 m
Draft (motor up)	19"	.5 m
Weight, dry	4,400 lbs	1,995.8 kg
Bridge clearance (no top)	6' 13"	1.9 m
Bridge clearance (w/ hardtop/bimini)	8' 2"	2.5 m
Bridge clearance (w/ hardtop & radar)	9' 0"	2.7 m
Height on trailer (no top)	9' 4"	2.8 m
Height on trailer (w/hardtop/bimini)	11' 4"	3.5 m
Height on trailer (w/hardtop & radar)	12' 2"	3.7 m
Fuel capacity	116 U.S. Gal	439.1 L
Water capacity	26 U.S. Gal	98.4 L
Holding tank capacity	13 U.S. Gal	49.2 L

**The Cutwater 24 Dual Console** - Cutwater Boats' sporty new offering is just as comfortable blasting around the lake with the kids in tow, as it is gliding along the shoreline for a sunset cruise. Designed and built to be a master of multiple functions, the C-24 DC provides exceptional versatility. Whether you're fishing, enjoying watersports, sightseeing, or entertaining guests, the new C-24 DC opens up a new world of exciting possibilities. Powered by a Yamaha 250, she is fast, efficient and fun. Our patented laminar flow interrupters provide smooth positive cornering and her deep V forward and double stepped hull gets on plane quickly. The private head with marine toilet is roomy, comfortable, and bright thanks to the frosted overhead skylight. Standard features include Garmin GPSMAP942xs chartplotter with GPS and depth sounder, aft beverage cooler, rod holders, locking rod storage, fishbox, large under-seat cooler, retractable ski pylon, pop up stainless cleats, and abundant drink holders throughout. Options include bow thruster, refrigerator, livewell, Bimini or hard top, electric grill and more.

# Using the C-24 Dual Console

## Entertaining -

- Forward seating area with table that converts to sun lounge.
- Doublewide reclining seat area in cockpit
- Large cooler capacities, two sinks, and optional electric grill and refrigerator
- Fusion stereo, bluetooth enabled with speakers throughout
- Comfortable, private head with marine toilet and deck pump out

## Day Cruising -

- Large fuel capacity, efficient 250 HP Yamaha outboard
- Efficient, high performance double-stepped hull
- Garmin navigation system
- Hydraulic steering, electric trim tabs, and our patented Laminar Flow Interrupters for a smooth, and comfortable ride
- Seven forward facing seats
- Optional hardtop or bimini with sun and sunset shades
- Insulated beverage cooler or livewell

## Watersports -

- Concealed ski-tow, installed centerline in the transom for straight tracking
- Large swimstep transom area with S.S. swim ladder and grab rail
- Rear facing seats
- Fresh water shower
- Large storage capacity for vests, ropes, gear
- Optional hardtop w/ sport racks and available upgraded stereo

## Fishing -

- Fish storage, rigging station, tackle storage
- Flush mounted rod holders
- Large, open cockpit area with toe rails
- Smooth gunwale surfaces and pop-up cleats
- Garmin navigation, GPS chartplotter with depth sounder and optional radar
- Optional livewell and raw water washdown
- Lockable rod and gear storage
- Large cooler capacities, two sinks, optional refrigerator
- Easy, clear walkway from swimstep to bow

## Performance/Hull

250 HP Yamaha outboard motor  
Double-stepped hull for increased efficiency and performance  
Laminar Flow Interrupters for smooth positive cornering (patented)  
Electric trim tabs  
Hydraulic steering

## Bow Area Features

Concealed anchor, bow roller, and optional windlass  
Concealed stainless steel foldout beaching ladder  
Large chain and rode storage with overboard drain  
Large, flat bow platform  
Rod holders  
Table, converts to sun lounge/ bed  
Fusion stereo speakers  
Drink holders  
Grab rails  
Large lockable storage area behind dash

## Helm & Cockpit Features

Nav package, Garmin 942xs, chartplotter w/GPS, depth sounder  
Single lever, electronic shift and throttle control  
Full color electronic engine control display  
Fusion stereo system, Bluetooth, AM/FM, aux input  
Doublewide passenger seat, seats four or converts to sun lounge  
Glare-reducing dash visor pad  
Spacious enclosed head with marine toilet and pump out  
Sink with folding faucet  
Cabinet storage  
Silverware/utensil drawer  
Rod holders  
Drink holders  
54" fish box  
Heavy duty cooler with integrated stowage compartment

## Transom and Swim Platform Features

Stainless steel boarding ladder  
Large livewell or fish box  
Integrated, draining cooler  
Transom shower  
Prep sink  
Concealed Ski Tow  
Fold out seat  
Fresh water shower

## Convenience

Pop-up cleats  
LED accent lighting with optional hardtop  
Padded bolsters throughout  
Abundant drink holders  
Dual seat footrest  
Marine head with holding tank and deck pumpout  
USB charging ports  
Transom entry door for easy boarding  
Windshield Wiper  
Anti-fog, self-venting glass windshield

## Construction

High density composite transom construction  
Fiberglass liner, self-bailing  
Nonskid surfaces throughout  
Foam-filled fiberglass stringer system

Stainless steel hardware  
Premium fabrics  
Vinylester barrier coat (hull)

## Safety

Built-in trailering lights (patented)  
Courtesy lights  
Handrails throughout  
Horn  
High gunwales with cockpit toe rails  
Illuminated compass  
Navigation lights  
Obstruction-free swimstep walkway  
VHF radio

## Available Factory Options

Hardtop	\$10,000
---Forward sunshade (HT only)	\$600
---HDX radar (HT only)	\$2,500
---Outriggers (HT only)	\$1,750
---Aft sunshade w/sunset shade (HT only)	\$800
---Solar panel and controller (HT only)	\$900
---Upgraded stereo (HT only)	\$750
Bimini Top	\$1,500
---Aft sunshade extension w/sunset shade (BT only)	\$800
---Forward sunshade extension (BT only)	\$600
Aluminum tandem axle trailer, electric/hyd brakes	\$10,740
Anchor pkg, 11# anchor, 15' chain, 150' line	\$330
Autopilot, Garmin w/remote	\$5,400
Aux. Yamaha 9.9 HP, bracket, remote steering	\$5,260
Bow thruster with extra battery	\$2,499
Canvas, Northwest Isinglass enclosure	\$1,750
Canvas, storage cover	\$2,500
Downrigger plugs and pads	\$370
Electric grill	\$800
Factory Delivery Experience	\$2,499
Garmin screen upgrade to 1242	\$2,500
Inverter	\$1,620
Livewell and raw water washdown	\$400
Macerator discharge	\$520
Refrigerator, 12V	\$850
Safety kit- fenders, lines, coast guard kit, first aid kit	\$740
Subwoofer, Fusion	\$300
Underwater lights	\$400
Windlass	\$1,199

## SPECIAL FACTORY DIRECT PRICING FROM

# \$99,937.00\*

\*Options, freight & taxes extra

## www.CutwaterBoats.com

Prices, specifications, equipment and options may change without notice. 1218  
17341 Tye St. SE Monroe, WA 98272 • Phone 800-349-7198 • CutwaterBoats.com

